



CX 01 30PE

ATTENZIONE

- non sezionare sotto tensione
- sezione cavi da impiegare: da 16 a 70 mm²
- usare con contatti a crimpare serie C30, disponibili a parte
- usare esclusivamente cavi flessibili di rame

CAUTION

- not for interrupting current
- for 6 to 2/0 AWG wires (16 to 70 mm²)
- use with crimp contacts series C30, to be ordered separately
- for copper stranded conductors only

ACHTUNG

- Nicht unter Spannung stecken und trennen
- Leiterquerschnitt: von 16 bis 70 mm²
- die Crimpkontakte der C30 Serie sind separat zu bestellen
- Nur flexible Kupferleitern benutzen

ATTENTION

- ne pas utiliser pour couper le courant
- section de câbles à employer : N° 6 jusqu'à 2/0 AWG (de 16 jusqu'à 70 mm²)
- à utiliser avec contacts à sertir série C30, à commander séparément
- employer seulement câbles flexibles en cuivre

ATENCIÓN

- no desconectar bajo tensión
- utilizar cable desde 16 hasta 70 mm² de sección
- para su uso con contactos de crimpado serie C30, que deben pedirse por separado
- utilizar exclusivamente cable flexible de cobre

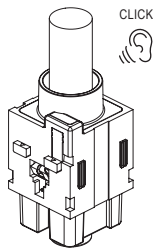
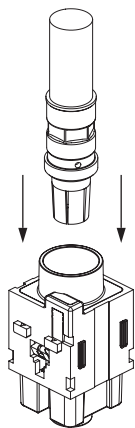

CONTACT INSERTION

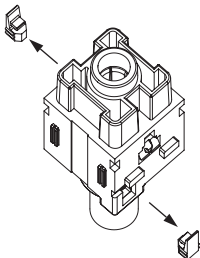
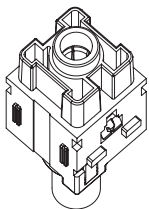

1

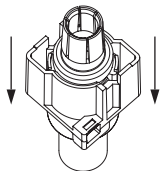
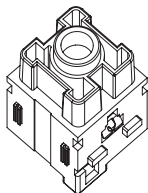

2

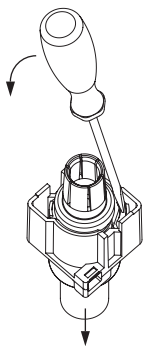

CONTACT REMOVAL

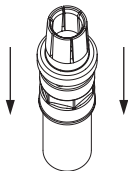
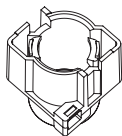

3