

Part number

# PE 3294 SI



Flush-mounting plug, PLUSO series, 3 poles + PE, 9 h (blue), 32 A, 200 ÷ 250 V

| Product description                           |   | Material properties          |   |
|---|---|------------------------------|---|
| <b>Product type</b>                           | Plug<br>Flush-mounting  | <b>Colour</b>                | RAL 7035 grey, RAL 5015 blue  |
| <b>Series</b>                                 | PE...SI, PLUSO  | <b>RoHs conformity</b>       | Compliant with exemption<br>6(c): copper alloy containing up to 4% lead by weight |
| <b>N. of poles</b>                            | 3 poles +  | <b>China RoHs - EFUP</b>     | 50  |
| <b>Clock position</b>                         | 9   | <b>REACH SVHC substances</b> | Yes<br>Lead   |
| <b>Size</b>                                   | Socket fixing centre distance 77 x 85 mm  | <b>SCIP number</b>           | Ca7de37f-add8-4b77-9861-279c94903ade  |
| Technical data                                |   | Approvals / Standards        |   |
| <b>Current</b>                                | 32 A  | <b>Reference standard</b>    | EN 60309-1 and -2   |
| <b>Voltage</b>                                | 200 ÷ 250 V   | General ordering information |   |
| <b>IP degree of protection</b>                | IP44  | <b>EAN13 code</b>            | 8015747068178   |
| Further technical details                     |   | Packaging Information        |   |
| <b>Weight</b>                                 | 222,00 g  | <b>Packaging length</b>      | 330,00 mm   |
| <b>Operating temperature range (min, max)</b> | -25°C ... +40°C   | <b>Packaging height</b>      | 175,00 mm   |
|   |   | <b>Packaging width</b>       | 295,00 mm   |
|   |   | <b>Packaging weight</b>      | 2,60 kg   |
|   |   | <b>Packaging volume</b>      | 17,04 dm <sup>3</sup>   |
|   |   | <b>Packaging description</b> | Carton box  |
|   |   | <b>Packaging quantity</b>    | 10 Pcs  |
|   |   | <b>Packaging EAN code</b>    | 8015747068185   |

Part number

# PE 3294 SI



Catalogue drawings

(16 / 32A) PE ... SI

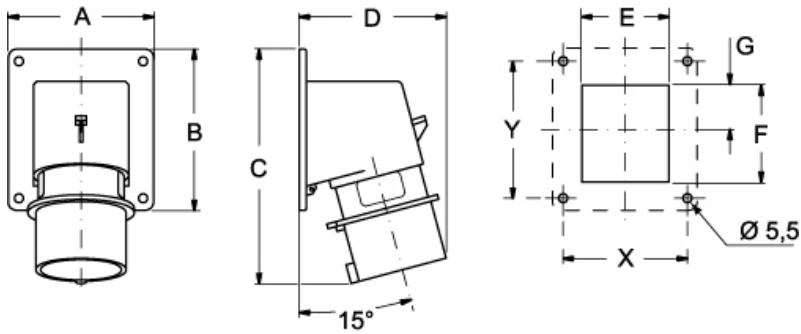

| PE ... SI       | A  | B   | C   | D   | E  | F  | G    | X  | Y  |
|-----------------|----|-----|-----|-----|----|----|------|----|----|
| <b>16A</b> 2P+⊕ | 65 | 82  | 126 | 81  | 41 | 43 | 21,5 | 52 | 60 |
| 3P+⊕            | 65 | 82  | 126 | 81  | 47 | 43 | 21,5 | 52 | 60 |
| 3P+N+⊕          | 90 | 100 | 146 | 93  | 54 | 60 | 27,5 | 77 | 85 |
| <b>32A</b> 2P+⊕ | 90 | 100 | 160 | 101 | 55 | 60 | 27,5 | 77 | 85 |
| 3P+⊕            | 90 | 100 | 160 | 101 | 55 | 60 | 27,5 | 77 | 85 |
| 3P+N+⊕          | 90 | 100 | 160 | 106 | 62 | 60 | 27,5 | 77 | 85 |