

Part number

DTWH J60.5MA

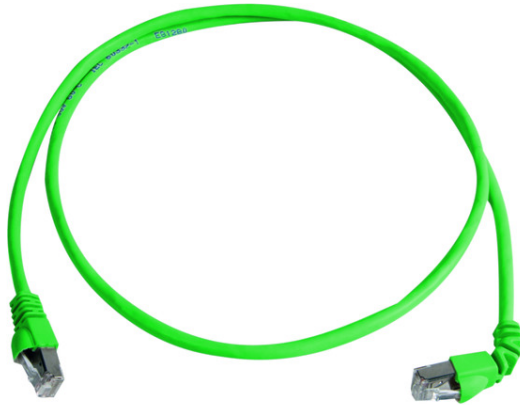

Male RJ45 connector, DTW patch cords series, Cat.6A, LSZH, cable 0,5 m, 1 angular and 1 straight cable entry

Product description

Product type	Data connector
Series	DTW patch cords
Connection type	RJ45
Gender	Male
Specification	Cat.6A, LSZH Cable 0,5 m, 1 angular and 1 straight cable entry

Further technical details

Mating cycles	≥ 750
Weight	10,00 g
Operating temperature range (min, max)	-40°C...+75°C
UL 94 flammability rating	V-0

Material properties

RoHs conformity	Compliant with exemption 6(c): copper alloy containing up to 4% lead by weight
China RoHs - EFUP	50
REACH SVHC substances	Yes Lead
SCIP number	8b60cf05-8f5f-42af-80f1-e79cea373159

General ordering information

EAN13 code	8015747242790
-------------------	---------------

Packaging Information

Packaging description	Carton box
Packaging quantity	1 Pcs
Packaging EAN code	8015747246538

Part number

DTWH J60.5MA



Catalogue drawings

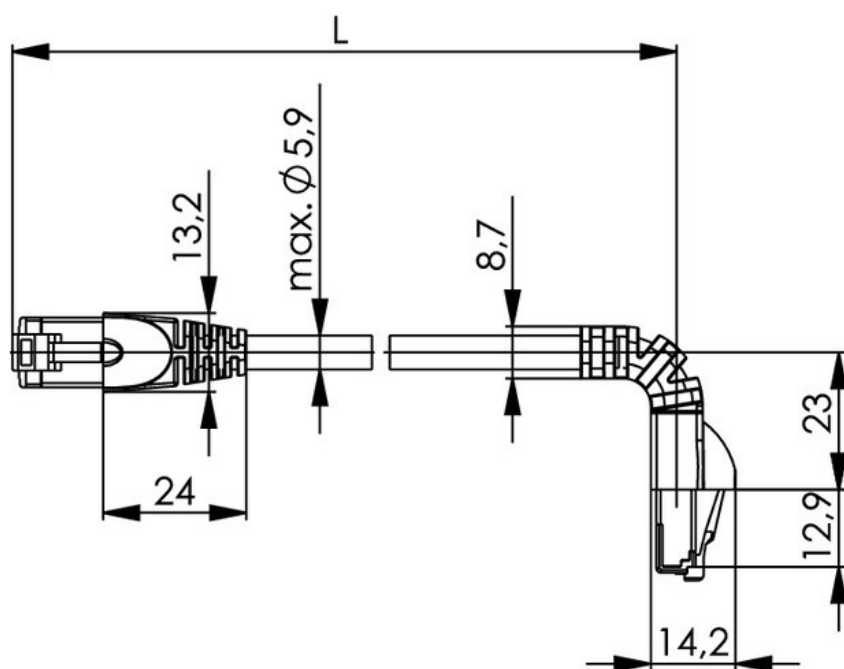

Notes