

Part number

CHPX 32 L29



Surface mounting housing, C-TYPE series, with 1 lever, Pg29 cable entry, size "77.62"



Product description		Material properties	
Product type	Surface mounting housing	Colour	RAL 7040 grey
Series	C-TYPE	RoHs conformity	Compliant
Closing type	With 1 lever	China RoHs - EFUP	E
Size	Size "77.62"	REACH SVHC substances	No
Cable entry	With cable entry Pg29	Approvals / Standards	
Technical data		Certifications	DNV, BV
IP degree of protection	IP66	UL	ECBT2
Further technical details		cUL	ECBT8
Operating temperature range (min, max)		General ordering information	
-40°C...+125°C		EAN13 code	8015747267205

Part number

CHPX 32 L29



Catalogue drawings

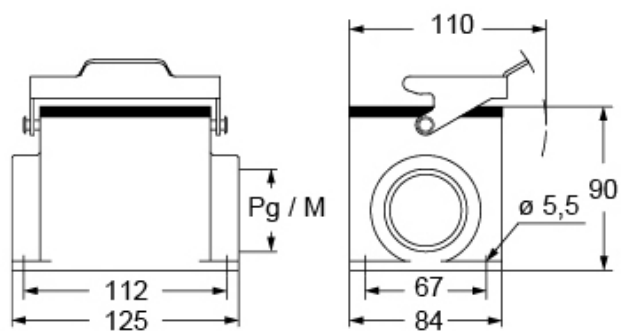

Notes