

Part number

CAVS 24.29



Hood, EMC series, with 4 pegs, Pg29 top cable entry, size "104.27", high construction

Product description

Product type	Hood
Series	EMC
Closing type	With 4 pegs
Size	Size "104.27"
Cable entry	Top cable entry Pg29
Specification	High construction

Technical data

IP degree of protection	IP65 / IP66 / IP69
--------------------------------	--------------------

Further technical details

Operating temperature range (min, max)	-40°C...+125°C
---	----------------

Material properties

RoHs conformity	Compliant
China RoHs - EFUP	E
REACH SVHC substances	No

Approvals / Standards

Certifications	DNV, BV
UL	ECBT2
cUL	ECBT8

General ordering information

EAN13 code	8015747147613
-------------------	---------------

Part number

CAVS 24.29



Catalogue drawings

CHOS (CAOS) - MHOS (MAOS)

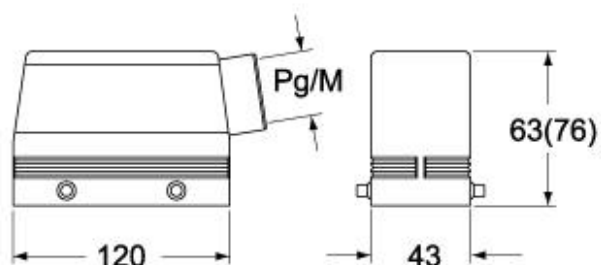

CHVS (CAVS) - MHVS (MAVS)

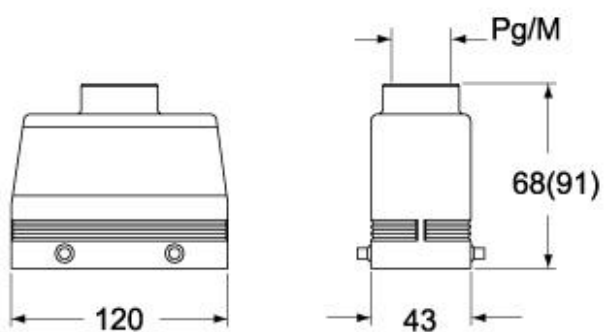

CHCS G

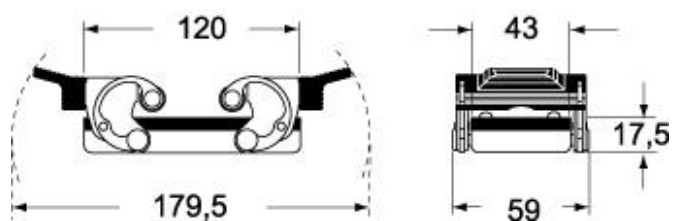

Notes