

Part number

MZ7PE 15L225



Surface mounting housing, E-Xtreme® CZ7 series, with 1 lever, M25 x 2 cable entry, size "49.16"

Product description

| | |
|---------------------|-----------------------------|
| Product type | Surface mounting housing |
| Series | E-Xtreme® CZ7 |
| Closing type | With 1 lever |
| Size | Size 49.16 |
| Cable entry | With cable entry M25 x 2 |

Technical data

| | |
|--------------------------------|--------------------|
| IP degree of protection | IP66 / IP67 / IP69 |
|--------------------------------|--------------------|

Further technical details

| | |
|---|----------------|
| Operating temperature range (min, max) | -40°C...+125°C |
|---|----------------|

Material properties

| | |
|------------------------------|------------------------|
| Other materials | Lever: Stainless steel |
| Colour | RAL 7016 grey |
| RoHs conformity | Compliant |
| China RoHs - EFUP | E |
| REACH SVHC substances | No |

Approvals / Standards

| | |
|------------|-------|
| UL | ECBT2 |
| cUL | ECBT8 |

General ordering information

| | |
|-------------------|---------------|
| EAN13 code | 8015747255097 |
| eCl@ss 8.1 | 27440202 |
| ETIM 7.0 | EC000437 |

Part number

MZ7PE 15L225



Catalogue drawings

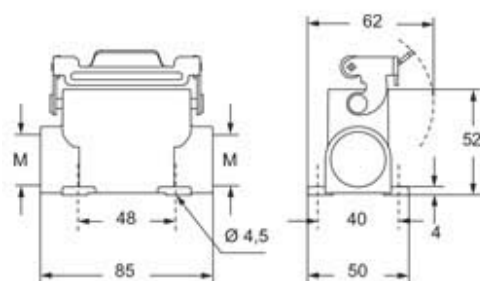

Notes

Dimensions shown in mm are not binding and may be changed without notice.
