

Part number

MFF 16.225



Hood, C-TYPE series, with 4 pegs, M25 x 2 double frontale cable entry without adapter, size "77.27", high construction

Product description		Material properties	
Product type	Hood	Colour	RAL 7040 grey
Series	C-TYPE	RoHs conformity	Compliant
Closing type	With 4 pegs	China RoHs - EFUP	E
Size	Size 77.27	REACH SVHC substances	No
Cable entry	Double side cable entry M25 x 2	Approvals / Standards	
Specification	High construction	Certifications	DNV, BV
Technical data		UL	ECBT2
IP degree of protection	IP65 / IP66 / IP69	cUL	ECBT8
Further technical details		General ordering information	
Weight	220,00 g	EAN13 code	8015747115285
Operating temperature range (min, max)	-40°C...+125°C	eCl@ss 8.1	27440202
		ETIM 7.0	EC000437
		Packaging Information	
		Sub-packaging weight	0,22 kg
		Sub-packaging description	Plastic packaging
		Sub-packaging quantity	1 Pcs
		Sub-packaging EAN barcode	8015747115346

Part number

MFF 16.225



Catalogue drawings

CAF - MAF/MFF

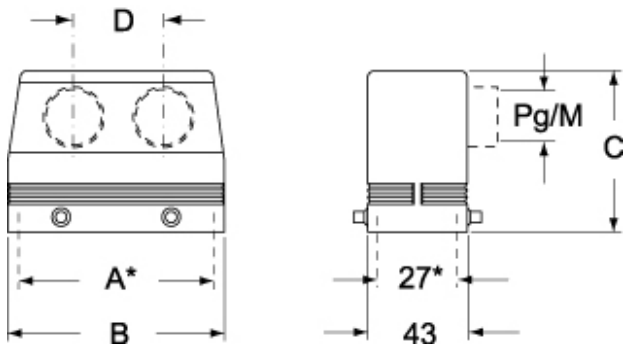

Notes

Dimensions shown in mm are not binding and may be changed without notice.
