

Part number

M7P 16.225



Surface mounting housing, V-TYPE series, with 2 levers, M25 x 2 cable entry, size "77.27"

Product description

Product type	Surface mounting housing
Series	V-TYPE
Closing type	With 2 levers
Size	Size 77.27
Cable entry	With cable entry M25 x 2

Technical data

IP degree of protection	IP66 / IP67 / IP69
--------------------------------	--------------------

Further technical details

Weight	340,00 g
Operating temperature range (min, max)	-40°C...+125°C

Material properties

Other materials	Lever: Stainless steel Gasket: NBR
Colour	RAL 7040 grey
RoHs conformity	Compliant
China RoHs - EFUP	E
REACH SVHC substances	No

Approvals / Standards

Certifications	DNV, BV
UL	ECBT2
cUL	ECBT8

General ordering information

EAN13 code	8015747060295
eCl@ss 8.1	27440202
ETIM 7.0	EC000437

Packaging Information

Packaging length	295,00 mm
Packaging height	160,00 mm
Packaging width	300,00 mm
Packaging weight	7,09 kg
Packaging volume	14,16 dm ³
Packaging description	Carton box
Packaging quantity	20 Pcs
Packaging EAN code	8015747044349
Sub-packaging weight	1,77 kg
Sub-packaging description	Plastic packaging
Sub-packaging quantity	5 Pcs
Sub-packaging EAN barcode	8015747044400

Part number

M7P 16.225



Catalogue drawings

C7P - C7AP M7P - M7AP

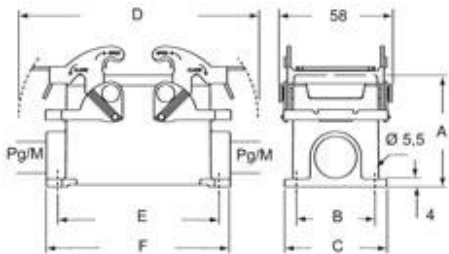

	A	B	C	D	E	F
C7P/M7P 10	57	40	52	122	82	93,5
C7P/M7P 16	63	45	57	142,5	105	117
C7P/M7P 24	63	45	57	169	132	144
C7AP/M7AP 10	73	45	57	122	82	93,5
C7AP/M7AP 16	77	45	57	142,5	105	117
C7AP/M7AP 24	80	45	57	169	132	144

Notes

The new lever, due to the vertical closing movement, offers an IP66/IP67 protection rating (according to EN 60529) when fitted with a complete and coupled connector and used with ILME standard hoods in die cast aluminum with pegs (without adaptor).

Dimensions shown in mm are not binding and may be changed without notice.