

Part number

JMPP 24.25



Surface mounting housing, JEI®-P series, with 2 levers, M25 cable entry, size 104.27

| Product description | | Material properties | |
|--|--------------------------|------------------------------|-------------------|
| Product type | Surface mounting housing | Colour | RAL 7040 grey |
| Series | JEI®-P | Approvals / Standards | |
| Closing type | With 2 levers | Certifications | DNV, BV |
| Size | Size "104.27" | UL | ECBT2 |
| Cable entry | With cable entry M25 | General ordering information | |
| Technical data | | EAN13 code | 8015747100922 |
| IP degree of protection | IP65 | Packaging Information | |
| Further technical details | | Packaging length | 475,00 mm |
| Weight | 354,00 g | Packaging height | 180,00 mm |
| Operating temperature range (min, max) | -40°C...+125°C | Packaging width | 200,00 mm |
| | | Packaging weight | 3,86 kg |
| | | Packaging volume | 17,10 dm³ |
| | | Packaging description | Carton box |
| | | Packaging quantity | 10 Pcs |
| | | Packaging EAN code | 8015747250023 |
| | | Sub-packaging weight | 1,93 kg |
| | | Sub-packaging description | Plastic packaging |
| | | Sub-packaging quantity | 5 Pcs |
| | | Sub-packaging EAN barcode | 8015747100946 |

Part number

JMPP 24.25



Catalogue drawings

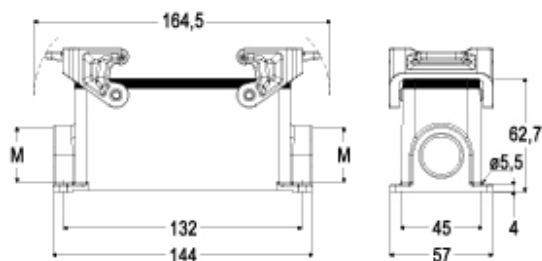

Notes

Dimensions shown in mm are not binding and may be changed without notice.