

Part number

# CHV 06 L16



Hood, C-TYPE series, with 2 pegs, Pg16 top cable entry, size "44.27"



#### Product description

|                     |                         |
|---------------------|-------------------------|
| <b>Product type</b> | Hood                    |
| <b>Series</b>       | C-TYPE                  |
| <b>Closing type</b> | With 2 pegs             |
| <b>Size</b>         | Size 44.27              |
| <b>Cable entry</b>  | Top cable entry<br>Pg16 |

#### Technical data

|                                |                    |
|--------------------------------|--------------------|
| <b>IP degree of protection</b> | IP65 / IP66 / IP69 |
|--------------------------------|--------------------|

#### Further technical details

|   |                |
|---|----------------|
| <b>Weight</b>                                 | 86,50 g        |
| <b>Operating temperature range (min, max)</b> | -40°C...+125°C |

#### Material properties

|                              |               |
|------------------------------|---------------|
| <b>Colour</b>                | RAL 7040 grey |
| <b>RoHs conformity</b>       | Compliant     |
| <b>China RoHs - EFUP</b>     | E             |
| <b>REACH SVHC substances</b> | No            |

#### Approvals / Standards

|                       |         |
|-----------------------|---------|
| <b>Certifications</b> | DNV, BV |
| <b>UL</b>             | ECBT2   |
| <b>cUL</b>            | ECBT8   |

#### General ordering information

|                   |               |
|-------------------|---------------|
| <b>EAN13 code</b> | 8015747024167 |
|-------------------|---------------|

#### Packaging Information

|                                  |                      |
|----------------------------------|----------------------|
| <b>Packaging length</b>          | 270,00 mm            |
| <b>Packaging height</b>          | 130,00 mm            |
| <b>Packaging width</b>           | 135,00 mm            |
| <b>Packaging weight</b>          | 1,89 kg              |
| <b>Packaging volume</b>          | 4,74 dm <sup>3</sup> |
| <b>Packaging description</b>     | Carton box           |
| <b>Packaging quantity</b>        | 20 Pcs               |
| <b>Packaging EAN code</b>        | 8015747024174        |
| <b>Sub-packaging weight</b>      | 0,47 kg              |
| <b>Sub-packaging description</b> | Plastic packaging    |
| <b>Sub-packaging quantity</b>    | 5 Pcs                |
| <b>Sub-packaging EAN barcode</b> | 8015747024181        |

Part number

# CHV 06 L16



Catalogue drawings

## CHO LX CHV LX - MHO LX MHV LX

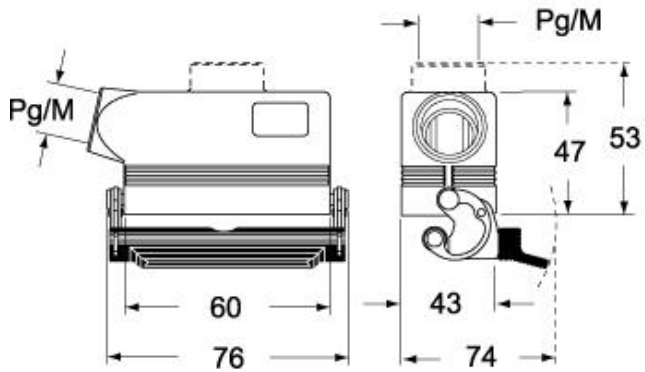

## CHV LG (CAV LG), MHV LG (MAV LG) [MFV LG]



## CHO L (CAO L) - MHO (MAO/MFO/MFV L) MHV L [MAV L]

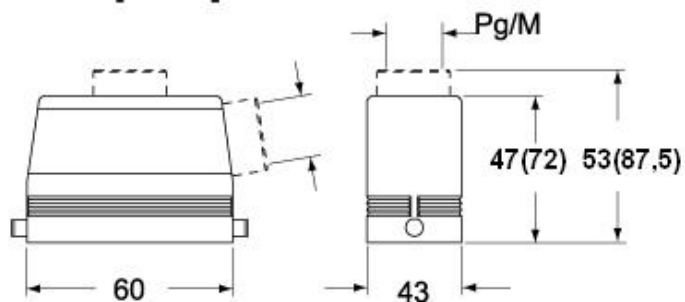

## Notes

Dimensions shown in mm are not binding and may be changed without notice.