

Part number

CHP 16 CS



Surface mounting housing, C-TYPE series, with 4 pegs, Pg21 cable entry, size "77.27", with metal cover

| Product description | | Material properties | |
|--|--------------------------|------------------------------|-----------------------|
| Product type | Surface mounting housing | Other materials | Gasket: NBR |
| Series | C-TYPE | Colour | RAL 7040 grey |
| Closing type | With 4 pegs | RoHs conformity | Compliant |
| Size | Size 77.27 | China RoHs - EFUP | E |
| Cable entry | With cable entry Pg21 | REACH SVHC substances | No |
| Specification | With metal cover | Approvals / Standards | |
| Technical data | | Certifications | DNV, BV |
| IP degree of protection | IP65 | UL | ECBT2 |
| Further technical details | | cUL | ECBT8 |
| Weight | 330,00 g | General ordering information | |
| Operating temperature range (min, max) | -40°C...+125°C | EAN13 code | 8015747022095 |
| | | Packaging Information | |
| | | Packaging length | 475,00 mm |
| | | Packaging height | 180,00 mm |
| | | Packaging width | 175,00 mm |
| | | Packaging weight | 3,60 kg |
| | | Packaging volume | 14,96 dm ³ |
| | | Packaging description | Carton box |
| | | Packaging quantity | 10 Pcs |
| | | Packaging EAN code | 8015747022101 |
| | | Sub-packaging weight | 1,80 kg |
| | | Sub-packaging description | Plastic packaging |
| | | Sub-packaging quantity | 5 Pcs |
| | | Sub-packaging EAN barcode | 8015747022118 |

Part number

CHP 16 CS



Catalogue drawings

CHP CAP - MHP MAP

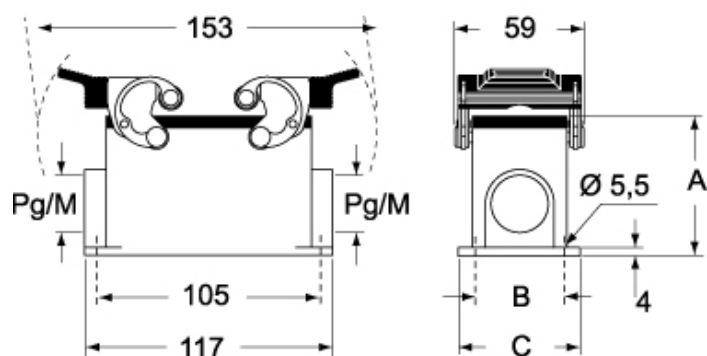

CHP CS/CP CAP CS/CP - MHP CS/CP MAP CS/CP

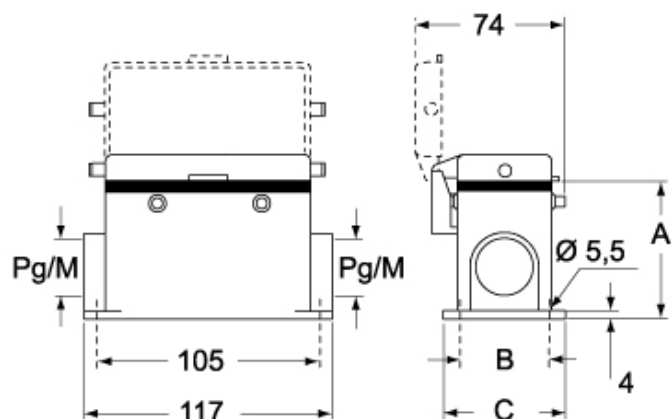

| | A |
|------------------------|----------|
| CHP / MHP | 63 |
| CAP / MAP | 77 |
| CHP CS / MHP CS | 63 |
| CAP CS / MAP CS | 77 |
| CHP CP / MHP CP | 63 |
| CAP CP / MAP CP | 77 |

Notes

Dimensions shown in mm are not binding and may be changed without notice.