

Part number

CHOR 24



Hood, 180 °C series, with 4 pegs, Pg21 side cable entry, size "104.27"

Product description

Product type	Hood
Series	180 °C
Closing type	With 4 pegs
Size	Size 104.27
Cable entry	Side cable entry Pg21

Technical data

IP degree of protection	IP65
--------------------------------	------

Further technical details

Weight	186,00 g
Operating temperature range (min, max)	-40°C ... +180°C

Material properties

RoHs conformity	Compliant
China RoHs - EFUP	E
REACH SVHC substances	No

Approvals / Standards

Certifications	DNV, BV
UL	ECBT2
cUL	ECBT8

General ordering information

EAN13 code	8015747020565
eCl@ss 8.1	27440202
ETIM 7.0	EC000437

Packaging Information

Sub-packaging weight	0,93 kg
Sub-packaging description	Plastic packaging
Sub-packaging quantity	5 Pcs
Sub-packaging EAN barcode	8015747098311

Part number

CHOR 24



Catalogue drawings

CHOR (CAOR) - MHOR (MAOR)

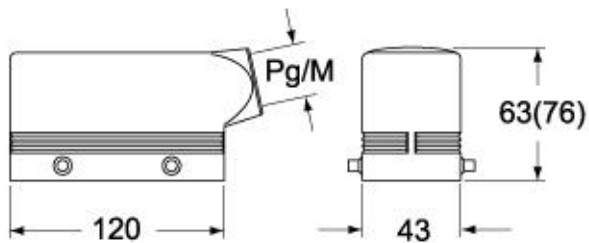

CHVR (CAVR) - MHVR (MAVR)

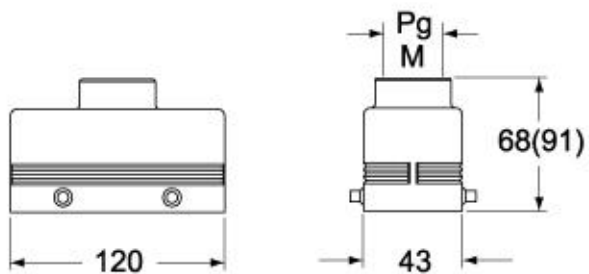

CHCR G

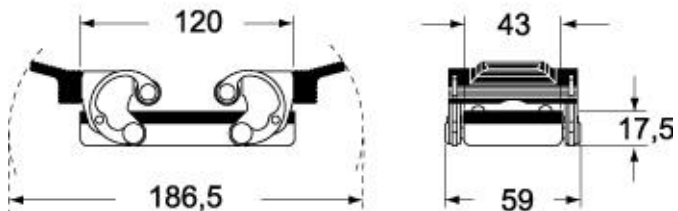

Notes

Dimensions shown in mm are not binding and may be changed without notice.
