

Part number

CAF 24.29



Hood, C-TYPE series, with 4 pegs, Pg29 frontal cable entry, size "104.27", high construction

Product description		Material properties	
Product type	Hood	Colour	RAL 7040 grey
Series	C-TYPE		Compliant with exemption
Closing type	With 4 pegs	RoHs conformity	6(c): copper alloy containing up to 4% lead by weight
Size	Size "104.27"	China RoHs - EFUP	50
Cable entry	Frontal cable entry with adapter Pg29	REACH SVHC substances	Yes Lead
Specification	High construction	SCIP number	15deaf78-e939-4401-a0b0-e2228ca32a03
Technical data		Approvals / Standards	
IP degree of protection	IP65 / IP66 / IP69	Certifications	DNV, BV
Further technical details		UL	ECBT2
Weight	275,00 g	cUL	ECBT8
Operating temperature range (min, max)	-40°C...+125°C	General ordering information	
		EAN13 code	8015747006002
		Packaging Information	
		Sub-packaging weight	0,28 kg
		Sub-packaging description	Plastic packaging
		Sub-packaging quantity	1 Pcs
		Sub-packaging EAN barcode	8015747195683

Part number

CAF 24.29



Catalogue drawings

**CHO [CAO] CHV (CAV) - MHO [MAO]
MHV (MAV)**

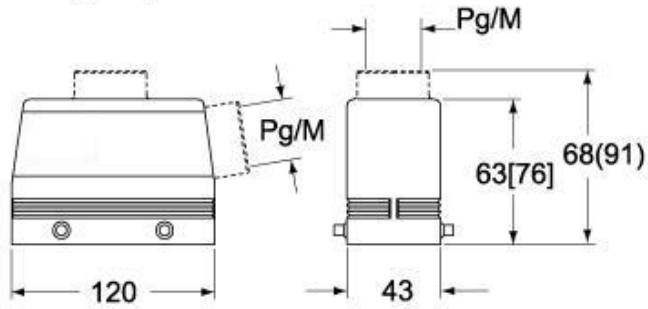

CHV G (CAV G) - MHV G (MAV G) - [MFV G]

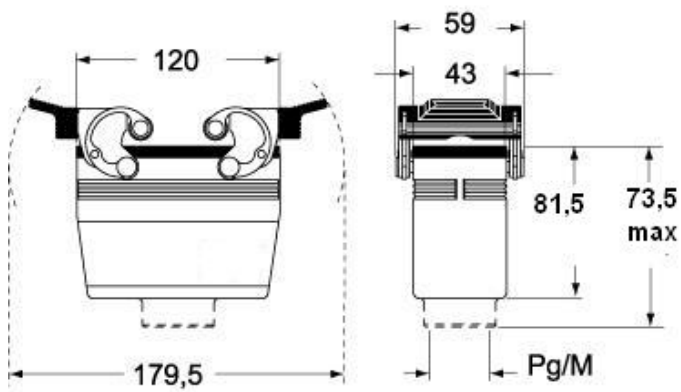

Notes

Dimensions shown in mm are not binding and may be changed without notice.