

Part number

# C7AP 10.21



Surface mounting housing, V-TYPE series, with 2 levers, Pg21 cable entry, size "57.27", high construction

## Product description

<b>Product type</b>	Surface mounting housing
<b>Series</b>	V-TYPE
<b>Closing type</b>	With 2 levers
<b>Size</b>	Size "57.27"
<b>Cable entry</b>	With cable entry Pg21
<b>Specification</b>	High construction

## Technical data

<b>IP degree of protection</b>	IP66 / IP67 / IP69
--------------------------------	--------------------

## Further technical details

<b>Weight</b>	380,00 g
<b>Operating temperature range (min, max)</b>	-40°C...+125°C

## Material properties

<b>Colour</b>	RAL 7040 grey
<b>RoHs conformity</b>	Compliant
<b>China RoHs - EFUP</b>	E
<b>REACH SVHC substances</b>	No
<b>Approvals / Standards</b>	
<b>Certifications</b>	DNV, BV
<b>UL</b>	ECBT2
<b>cUL</b>	ECBT8

## General ordering information

<b>EAN13 code</b>	8015747060271
-------------------	---------------

## Packaging Information

<b>Packaging length</b>	250,00 mm
<b>Packaging height</b>	145,00 mm
<b>Packaging width</b>	300,00 mm
<b>Packaging weight</b>	4,00 kg
<b>Packaging volume</b>	10,88 dm <sup>3</sup>
<b>Packaging description</b>	Carton box
<b>Packaging quantity</b>	10 Pcs
<b>Packaging EAN code</b>	8015747248822
<b>Sub-packaging weight</b>	2,00 kg
<b>Sub-packaging description</b>	Plastic packaging
<b>Sub-packaging quantity</b>	5 Pcs
<b>Sub-packaging EAN barcode</b>	8015747115230

Part number

# C7AP 10.21



## Catalogue drawings

C7P - C7AP M7P - M7AP

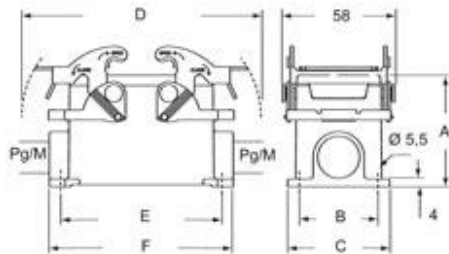

	A	B	C	D	E	F
<b>C7P/M7P 10</b>	57	40	52	122	82	93,5
<b>C7P/M7P 16</b>	63	45	57	142,5	105	117
<b>C7P/M7P 24</b>	63	45	57	169	132	144
<b>C7AP/M7AP 10</b>	73	45	57	122	82	93,5
<b>C7AP/M7AP 16</b>	77	45	57	142,5	105	117
<b>C7AP/M7AP 24</b>	80	45	57	169	132	144

## Notes

The new lever, due to the vertical closing movement, offers an IP66/IP67 protection rating (according to EN 60529) when fitted with a complete and coupled connector and used with ILME standard hoods in die cast aluminum with pegs (without adaptor).

Dimensions shown in mm are not binding and may be changed without notice.