

Part number

# C30MA 35



Male crimp contact, C30 series, 300 A, turned silver plated, wire cross section 35 mm<sup>2</sup>, AWG 2

Product description		Material properties	
Product type	Crimp contact	Main material	Copper alloy
Series	C30		Compliant with exemption 6(c): copper alloy containing up to 4% lead by weight
Gender	Male	RoHs conformity	
Technical data		China RoHs - EFUP	50
Current	300 A	REACH SVHC substances	Yes Lead
Wire cross-section	35,00 mm <sup>2</sup>	General ordering information	
AWG size	2	EAN13 code	8015747290265
Contact type	Turned silver plated	Packaging Information	
Further technical details		Packaging length	112,00 mm
Contact resistance	≤ 0,2 mΩ	Packaging height	95,00 mm
Weight	31,20 g	Packaging width	117,00 mm
Conductors stripping length	20 mm	Packaging volume	1,24 dm <sup>3</sup>
		Packaging description	Carton box
		Packaging quantity	40 Pcs
		Packaging EAN code	8015747290272
		Sub-packaging description	Plastic box
		Sub-packaging quantity	5 Pcs
		Sub-packaging EAN barcode	8015747290289

Part number

# C30MA 35



## Catalogue drawings

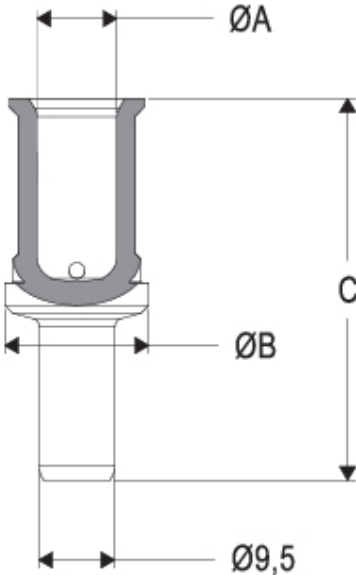

### C30MA contacts

conductor section (mm <sup>2</sup> )	conductor slot ø A (mm)	ø B (mm)	C (mm)	conductor stripping length (mm)
16	5,5	18	42,7	19
25	7	18	42,7	19
35	8,2	18	43,7	20
50	10	18	49,2	22,5
70	11,5	18	49,2	22,5
95	13,5	21	49,2	22,5
120	15,5	21	49,2	22,5

## Notes

### California Proposition 65 Information



### WARNING

This product can expose you to lead and its compounds, known to the State of California to cause cancer and/or reproductive toxicity. For more information go to [www.P65Warnings.ca.gov](http://www.P65Warnings.ca.gov).

Dimensions shown in mm are not binding and may be changed without notice.