

Part number

MKAXW IAP25



Brief description:

angled bulkhead mounting housing with cable entry, with single lever, size "21.21", M25, W-TYPE version for aggressive environments, IP44 (IP66/IP67/IP69 with CKR 65/CKR 65 D kits)

Product description

Version	W-TYPE version for aggressive environments
Series	Angled mounting housings with 1 lever
Product type	with stainless steel lever
Variant	with threaded entry
Style	Fixing by 4 screws
Family	CLASS enclosures
Size	size "21.21"

Technical data

Operating temperature range (min, max)	-40 °C ... +125 °C
Material	metal
IP degree of protection	IP44 (IP66/IP67/IP69 with CKR 65/CKR 65 D kits)
Cable entry	M25

Further technical details

Weight	0,10 g
---------------	--------

General ordering information

EAN13 code	8015747250887
-------------------	---------------

Packaging Information

Packaging volume	6,89 dm ³
Packaging description	Carton box
Packaging quantity	100 Pcs
Packaging EAN code	8015747250894
Sub-packaging length	210,00 mm
Sub-packaging height	40,00 mm
Sub-packaging width	175,00 mm
Sub-packaging volume	1,47 dm ³
Sub-packaging description	Carton box
Sub-packaging quantity	10 Pcs
Sub-packaging EAN barcode	8015747250900

Part number

MKAXW IAP25



Catalogue drawings

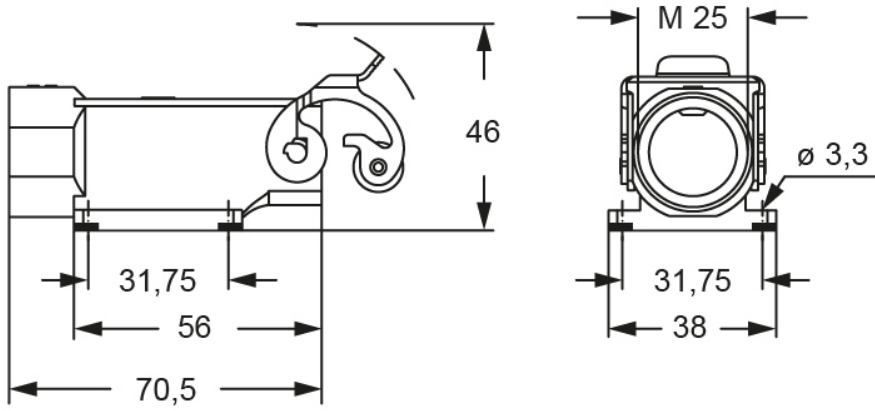

Catalogue drawings

