

Part number

CZAP 25LS221



Surface mounting housing, IL-BRID series, with 1 lever, Pg21 x 2 cable entry, size "66.16", high construction, with metal cover

Product description		Material properties	
Product type	Surface mounting housing	Other materials	Lever: Polyamide (PA) and Stainless steel core
Series	IL-BRID	Colour	RAL 7040 grey
Closing type	With 1 lever	RoHs conformity	Compliant
Size	Size "66.16"	China RoHs - EFUP	E
Cable entry	With cable entry Pg21 x 2	REACH SVHC substances	No
Specification	High construction, with metal cover	Approvals / Standards	
Technical data		UL	ECBT2
IP degree of protection	IP65 / IP66 / IP69	cUL	ECBT8
Further technical details		General ordering information	
Weight	240,00 g	EAN13 code	8015747043410
Operating temperature range (min, max)	-40°C...+125°C	Packaging Information	
		Packaging length	190,00 mm
		Packaging height	125,00 mm
		Packaging width	330,00 mm
		Packaging weight	2,70 kg
		Packaging volume	7,84 dm³
		Packaging description	Carton box
		Packaging quantity	10 Pcs
		Packaging EAN code	8015747043427

Part number

CZAP 25LS221



Catalogue drawings

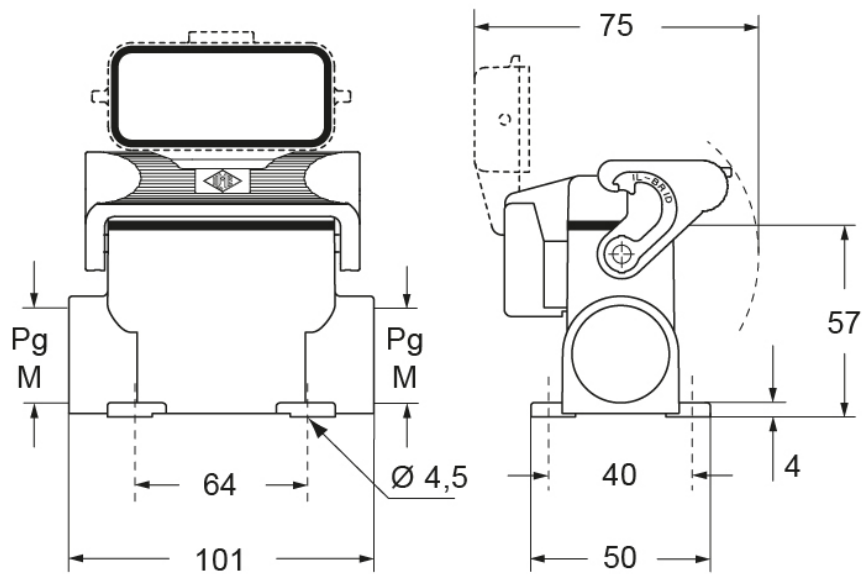

Notes

Dimensions shown in mm are not binding and may be changed without notice.