

Part number

CZAP 25 LS21



Surface mounting housing, IL-BRID series, with 1 lever, Pg21 cable entry, size "66.16", high construction, with metal cover

Product description		Material properties	
Product type	Surface mounting housing	Other materials	Lever: Polyamide (PA) and Stainless steel core
Series	IL-BRID	Colour	RAL 7040 grey
Closing type	With 1 lever	RoHs conformity	Compliant
Size	Size "66.16"	China RoHs - EFUP	E
Cable entry	With cable entry Pg21	REACH SVHC substances	No
Specification	High construction, with metal cover	Approvals / Standards	
Technical data		UL	ECBT2
IP degree of protection	IP65 / IP66 / IP69	cUL	ECBT8
Further technical details		General ordering information	
Weight	217,00 g	EAN13 code	8015747232241
Operating temperature range (min, max)	-40°C...+125°C	Packaging Information	
		Packaging length	190,00 mm
		Packaging height	125,00 mm
		Packaging width	330,00 mm
		Packaging weight	2,44 kg
		Packaging volume	7,84 dm³
		Packaging description	Carton box
		Packaging quantity	10 Pcs
		Packaging EAN code	8015747232258
		Sub-packaging weight	1,22 kg
		Sub-packaging description	Plastic packaging
		Sub-packaging quantity	5 Pcs
		Sub-packaging EAN barcode	8015747232265

Part number

CZAP 25 LS21



Catalogue drawings

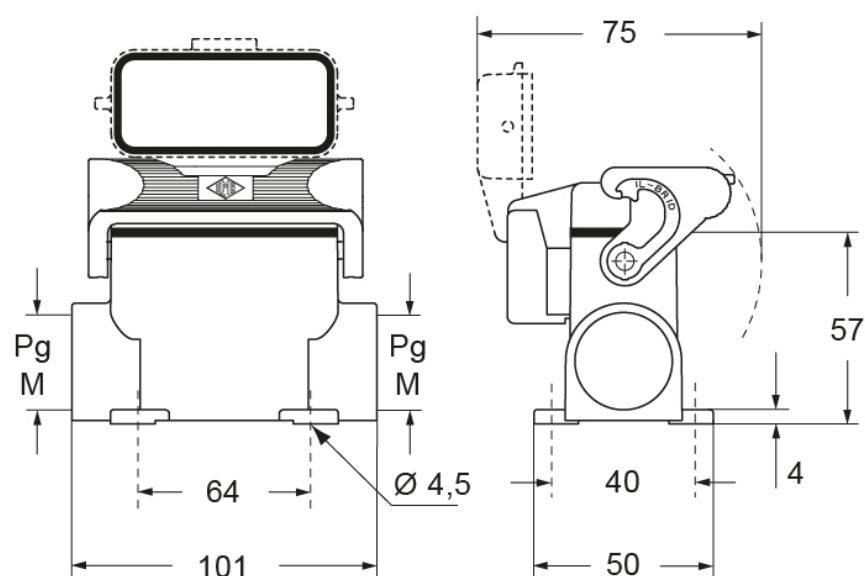

Notes

Dimensions shown in mm are not binding and may be changed without notice.