

Part number  
**CR SP**



Supports for inserts, with fixing screws and washers for earth connection, kit with 2 pcs

Product description		General ordering information	
Product type	Supports for inserts	EAN13 code	8015747114615
Specification	With fixing screws and washers for earth connection Kit with 2 pcs	eCl@ss 8.1	27449290
Further technical details		ETIM 7.0	EC002943
Weight		Packaging Information	
70,00 g		Packaging length	112,00 mm
		Packaging height	95,00 mm
		Packaging width	117,00 mm
		Packaging weight	0,72 kg
		Packaging volume	1,24 dm <sup>3</sup>
		Packaging description	Carton box
		Packaging quantity	10 Pcs
		Packaging EAN code	8015747231411
		Sub-packaging weight	0,07 kg
		Sub-packaging description	Plastic bag
		Sub-packaging quantity	1 Pcs
		Sub-packaging EAN barcode	8015747114646

# Part number CR SP



Catalogue drawings

Catalogue drawings

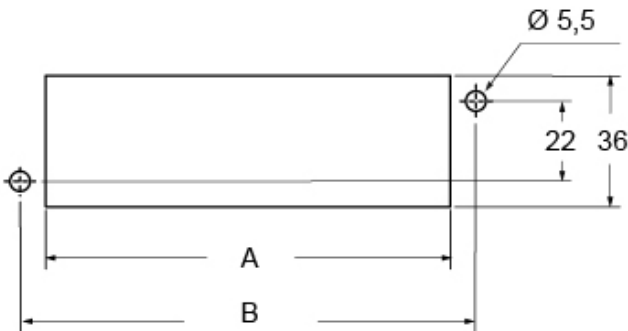
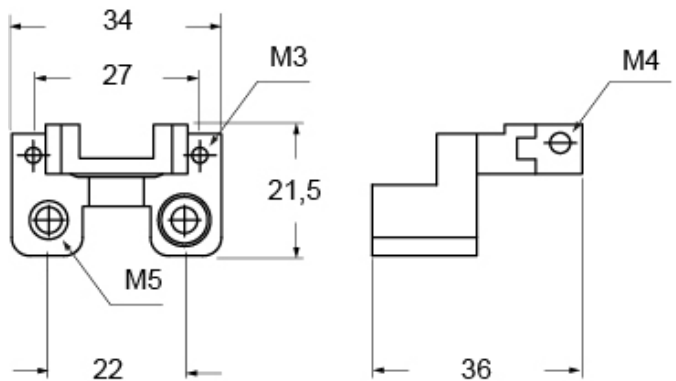

poles	06	10	16	24
A	52	65	85,5	112
B	65	78	98,5	125

## Notes

Dimensions shown in mm are not binding and may be changed without notice.

In the fixed part, a pair of CR SP supports is fitted on the connector, using its securing screws. A CR..FS or CR..SS anchorage is fitted on the supports, using the supplied securing screws and washers. All parts are secured on the rear panel with the pair of CR 26 V viton screws.

In the mobile part too, a pair of CR SP supports are fitted on the connector and a CR..FS or CR..SS anchorage is secured on it. The pair of CR 42 V screws fasten the mobile part to the fixed part.

Note: By unscrewing the CR 26 V panel screws, the whole assembly (mobile part + fixed part) can be removed from the panel for inspection.

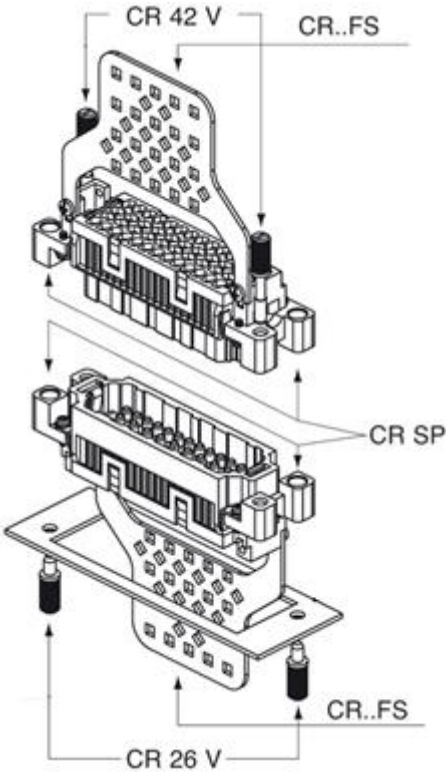

1. panel
2. mobile part
3. fixed part