

Part number

CMP 03 L



Surface mounting housing, 830V series, with 1 lever, Pg16 cable entry, size "57.27"

Product description

Product type	Surface mounting housing
Series	830V
Closing type	With 1 lever
Size	Size 57.27
Cable entry	With cable entry Pg16

Technical data

IP degree of protection	IP65 / IP66 / IP69
--------------------------------	--------------------

Further technical details

Weight	228,00 g
Operating temperature range (min, max)	-40°C...+125°C

Material properties

Colour	RAL 7040 grey
RoHs conformity	Compliant
China RoHs - EFUP	E
REACH SVHC substances	No

Approvals / Standards

Certifications	DNV, BV
UL	ECBT2
cUL	ECBT8

General ordering information

EAN13 code	8015747031295
-------------------	---------------

Packaging Information

Packaging weight	2,32 kg
Packaging description	Carton box
Packaging quantity	10 Pcs
Packaging EAN code	8015747263085
Sub-packaging weight	1,16 kg
Sub-packaging description	Plastic packaging
Sub-packaging quantity	5 Pcs
Sub-packaging EAN barcode	8015747031301

Part number

CMP 03 L



Catalogue drawings

CMP L CMAP L - MMP L MMAP L

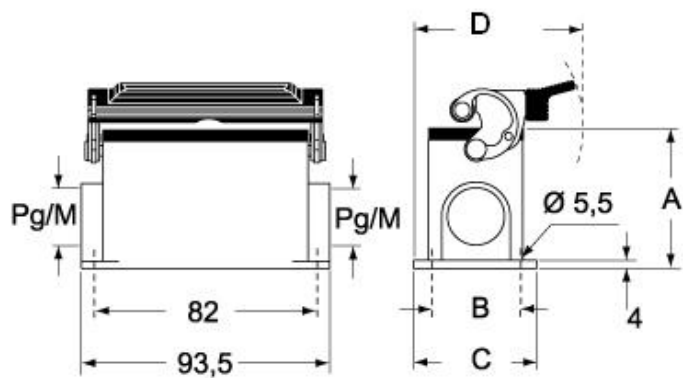

CMP LS CMAP LS - MMP LS MMAP LS

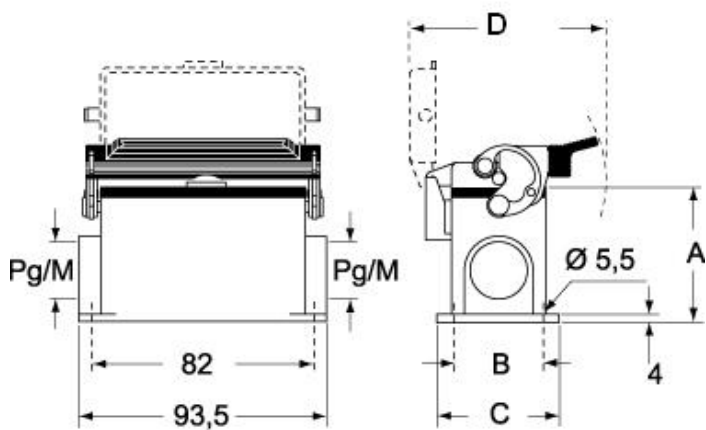

Notes

Dimensions shown in mm are not binding and may be changed without notice.