

Part number

CMAP 03 LS



Surface mounting housing, 830V series, with 1 lever, Pg21 cable entry, size "57.27", high construction, with metal cover

Product description

| | |
|----------------------|-------------------------------------|
| Product type | Surface mounting housing |
| Series | 830V |
| Closing type | With 1 lever |
| Size | Size 57.27 |
| Cable entry | With cable entry Pg21 |
| Specification | High construction, with metal cover |

Technical data

| | |
|--------------------------------|------|
| IP degree of protection | IP65 |
|--------------------------------|------|

Further technical details

| | |
|---|----------------|
| Weight | 400,00 g |
| Operating temperature range (min, max) | -40°C...+125°C |

Material properties

| | |
|------------------------------|---------------|
| Colour | RAL 7040 grey |
| RoHs conformity | Compliant |
| China RoHs - EFUP | E |
| REACH SVHC substances | No |

Approvals / Standards

| | |
|-----------------------|---------|
| Certifications | DNV, BV |
| UL | ECBT2 |
| cUL | ECBT8 |

General ordering information

| | |
|-------------------|---------------|
| EAN13 code | 8015747029070 |
|-------------------|---------------|

Packaging Information

| | |
|----------------------------------|-------------------|
| Sub-packaging weight | 2,00 kg |
| Sub-packaging description | Plastic packaging |
| Sub-packaging quantity | 5 Pcs |
| Sub-packaging EAN barcode | 8015747104388 |

Part number

CMAP 03 LS



Catalogue drawings

CMP L CMAP L - MMP L MMAP L

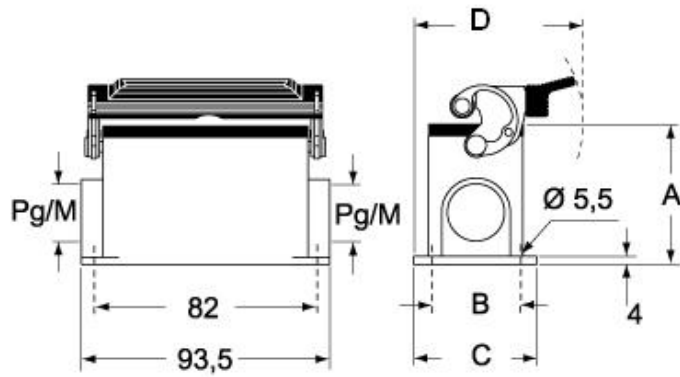

CMP LS CMAP LS - MMP LS MMAP LS

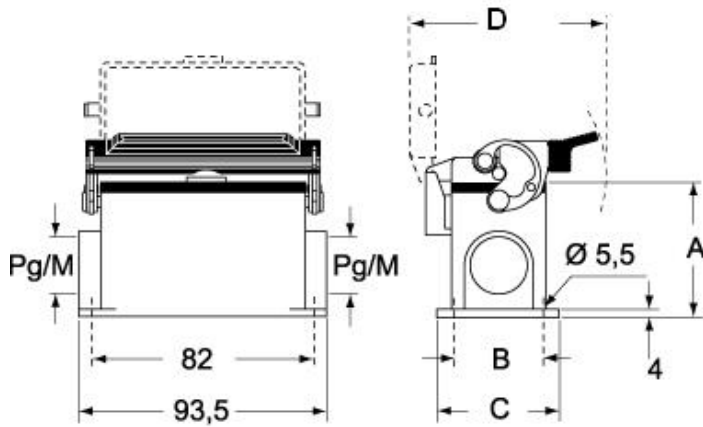

Notes

Dimensions shown in mm are not binding and may be changed without notice.