

Part number

# C7P 06 L



Surface mounting housing, V-TYPE series, with 1 lever, Pg16 cable entry, size "44.27"

Product description		Material properties	
Product type	Surface mounting housing	Other materials	Lever: Stainless steel Gasket: NBR
Series	V-TYPE	Colour	RAL 7040 grey
Closing type	With 1 lever	RoHs conformity	Compliant
Size	Size 44.27	China RoHs - EFUP	E
Cable entry	With cable entry Pg16	REACH SVHC substances	No
Technical data		Approvals / Standards	
IP degree of protection	IP66 / IP67 / IP69	Certifications	DNV, BV
Further technical details		UL	ECBT2
Weight	197,00 g	cUL	ECBT8
Operating temperature range (min, max)	-40°C...+125°C	General ordering information	
		EAN13 code	8015747093538
Packaging Information			
Packaging length	285,00 mm	Packaging description	Carton box
Packaging height	170,00 mm	Packaging quantity	20 Pcs
Packaging width	190,00 mm	Packaging EAN code	8015747178174
Packaging weight	4,04 kg	Sub-packaging weight	1,01 kg
Packaging volume	9,21 dm <sup>3</sup>	Sub-packaging description	Plastic packaging
		Sub-packaging quantity	5 Pcs
		Sub-packaging EAN barcode	8015747178181

Part number

# C7P 06 L



## Catalogue drawings

C7P L - C7AP L M7P L - M7AP L

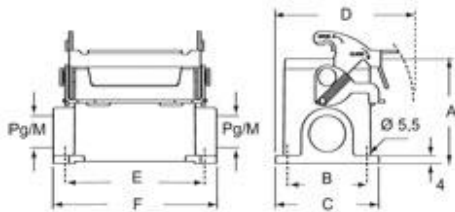

	A	B	C	D	E	F
C7P/M7P 06 L	53	40	52	70	70	82
C7AP/M7AP 06 L	73	45	57	72,5	70	82

## Notes

### C7P/M7P:

Due to the vertical closing movement, the new lever offers an IP66/IP67 protection (according to EN 60529) when fitted with a complete and coupled connector and used with ILME standard hoods in die cast aluminum with pegs (without adaptor).

Dimensions shown in mm are not binding and may be changed without notice.